



Maritime &
Coastguard
Agency

The mandatory sections of this plan have been approved by the Maritime and Coastguard Agency for the compliance with the Merchant Shipping (Port Waste Reception Facilities Regulations) as amended.



Marine Surveyor S. Twitchin Date 25/05/2023
Southampton Marine Office *S. Twitchin* Pages 14

LYMINGTON HARBOUR

Port Waste Management Plan

Created by:

Nick Tattersall

Operations Manager

Authorised by:

Ryan Willegers

Harbour Master

Date:

19 May 2023

Review Information	
Last MCA Revalidation Date of Plan	6 August 2022
Next MCA Revalidation Due	5 August 2025
Next Interim Review Due	May 2024



Revision Record		
Revision	Detail of Change	Date of Change
10	Document redrafted, minor text changes, ICW included.	29 July 2022
11	LHC/LYH reciprocal arrangement for disposal of oil and ICW added. Lymington Marina / Berthon Boat Company changes to App 2.7, 2.8, 2.9 & 2.13 included.	19 May 2023



Contents

1. Introduction3

2. Summary.....3

3. General Principles3

4. Consultees.....4

5. Waste Quantities.....4

6. Non-Compliance.....4

7. Specific Operator Plans4

 Lymington Harbour Commissioners4

 Lymington Yacht Haven (see further detail at Annex 1).....5

 Lymington Marina incorporating Berthon Boat Co. (See further detail at Annex 2).....6

 Yacht Clubs.....6

 Wightlink Ltd.....6

8. Time Expired Pyrotechnics (TEPs)6

 Leisure Users6

 Commercial Organisations7

9. Review.....7

Appendix 1 Lymington Yacht Haven.....8

Appendix 2 Lymington Marina / Berthon Boat Company11



1. Introduction

Since January 1998 UK legislation has required ports, harbours and some terminals to draw up waste management plans for Maritime and Coastguard Agency (MCA) approval. The UK requirements for Port Waste management have since been updated with the Merchant Shipping and Fishing Vessels (Port Waste Reception Facilities) Regulations 2003 and amendments. Guidance on the implementation of these regulations in the UK is provided in MGN 563 (M+F).

The Harbour Master is the Designated Person for the implementation of this plan and may be contacted at the Harbour Office, Bath Road, Lymington, SO41 3SE: Tel 01590 672014.

2. Summary

Lymington Harbour caters for two principle marine activities, i.e.

1. Recreational craft comprising approximately 1,600 permanent berths with visiting yachts and supporting services.
2. A ferry terminal owned and operated by the ferry company Wightlink Ltd providing a domestic ro-ro vehicle and foot passenger service between Lymington and Yarmouth, Isle of Wight. Wightlink are the Statutory Harbour Authority for their terminal and produce their own Port Waste Management Plan for certification by the MCA. As soon as their vessels leave the terminal berths they enter harbour waters controlled by Lymington Harbour Commissioners.

Other than Wightlink (see 2 above), there are no harbour facilities for commercial shipping.

3. General Principles

- a) Harbour Areas to be covered.

Town Quay	Recreational craft & fishing boats
Lymington Marina	Recreational craft
Lymington Yacht Haven	Recreational craft
Bath Road Car Park	Recreational craft (Incorporates Yacht/Sailing Clubs)
Wightlink Terminal	Commercial – Domestic Ferry Service (see Wightlink PWMP)

- b) Charging: Part of Marina/LHC mooring charges are for waste. As such, customers are reminded to place waste and refuse in the appropriate receptacles provided.



4. Consultees

Lymington Harbour Commissioners	Chief Executive/Harbour Master
Lymington Marina (Berthon)	Yard Manager
Lymington Yacht Haven	Office Manager
Royal Lymington Yacht Club	General Manager - Operations
Lymington Town Sailing Club	Secretary

Consultees are asked on an annual basis to review their plans and advise LHC of any updates prior to submission to the MCA. Members of the public have the opportunity to submit their comments or complaints either in person at the Harbour Office or via the “Contact Us” facility on the LHC website.

5. Waste Quantities

These are highest during the summer season but vary by area. Waste and recycling bins are emptied according to demand by licenced waste contractors who retain records of collection and disposal in accordance with their waste carrier licence conditions.

6. Non-Compliance

Non-compliance issues are dealt with under the Lymington Harbour General Directions 2014. Direction 5.27 prohibits acts of pollution and Direction 6.3 requires waste products to be placed in the appropriate facilities. Any breaches of the Directions will be dealt with in accordance with LHC’s Enforcement and Prosecution Policy in its Marine Safety Management Plan.

The MCA shall be notified of any vessels identified as being non-compliant. Contact details are:-

Environmental Policy Branch

Maritime and Coastguard Agency, Bay 2/29

Spring Place, 105 Commercial Road, Southampton, SO15 1EG.

Tel: +44 (0) 203 8172448

E-mail: environment@mcga.gov.uk

7. Specific Operator Plans

Lymington Harbour Commissioners

Town Quay

Mobile wheelie bins are provided for visiting yachts and fishing boats for solid waste, Dry Mixed Recycling and glass recycling in conjunction with New Forest District Council (NFDC), Appletree Court, Beaulieu Road, Lyndhurst SO43 7PA, Tel 02380 285000. Bins are located in a bin store next to toilet and shower block adjacent to gangway. Emptying by NFDC takes place as necessary (minimum weekly) via an annual Season Ticket. Waste Carrier Licence CBDL45387.



Dan Bran & Harbour Masters Pontoon

Mobile wheelie bins are located at the pontoon bridge for visiting and resident yachts.

New Forest District Council (NFDC), Appletree Court, Beaulieu Road, Lyndhurst SO43 7PA provides and empties 5 x 240l bins for solid waste (weekly collection). Waste Carrier Licence CDBL45387.

BIFFA Waste Services Limited, Coronation Road, Cressex, High Wycombe, Buckinghamshire HP12 3TZ provides and empties 1 x 660l mixed recycling (weekly collection) and 1 x 240l glass recycling bins (fortnightly collection). Waste Carrier Licence CBDU104360.

Details of the above facilities and their locations are provided in a 'Harbour Guide' publication which is given to mooring holders and visiting yachts.

International Catering Waste

LHC provides a limited service for the disposal of International Catering Waste (ICW). Vessels that wish to dispose of ICW are requested to contact the Harbour Office. On receipt of the request the vessel shall be issued with a bin bag in which to place their ICW. Once sealed, the bag shall be placed in the ICW container (a 205l metal clip top drum) in the LHC yard. The ICW contractor shall be notified and the contents of the bin disposed of in accordance with the DEFRA guidance. The contractor is Veolia, Marchwood Treatment Works, Area 6 Oceanic Way, Marchwood Ind. Park, Southampton SO40 4BD. Waste Carrier Licence CBDU95537.

River users are notified of the service via LHC's website, the Harbour Guide, Local Notice to Mariners and by signage on the Harbour Master and Town Quay pontoons.

Other Waste not covered above

As necessary the Harbour Master hires licenced contractors to provide skips to collect hard waste found floating in the river and to deal with special situations.

Sewage pump-out facilities are available at Lymington Yacht Haven (LYH) and customers requiring this facility are directed there. There is a separate fee for use of this facility, payable directly to LYH. Details of this facility are provided in the 'Harbour Guide' and via the LHC website.

LHC has a quid pro quo agreement with Lymington Yacht Haven (LYH can direct customers to use LHC's ICW facility) for the disposal of LHC's own waste oil up to 10 litres per annum at their waste disposal station. Advance notification required before each disposal.

Lymington Yacht Haven (see further detail at Annex 1)

1. Eight mobile skips are provided and rubbish is then processed in an on-site waste compactor which is emptied once a month (out of season), and twice a month during the season. Skips all bear notices indicating that they are not to be used for non-EU food waste.
2. Waste oil tanks are provided close to each skip and emptied by an outside contractor as required.
3. Separator tanks are available for contaminated bilge water.
4. Discarded batteries and scrap metal are collected by **Harry Frankcom - Waste Carrier Licence Number CBDU275291.**
5. Glass recycling is available with collection by NFDC.



6. Black/grey water pump-out connected directly to the main public foul sewer.
7. Two skips are provided for cardboard recycling, scrap metal and TEPs collected as required.
8. These arrangements are set out in a handbook issued to all mooring holders and visitors.

Lymington Marina incorporating Berthon Boat Co. (See further detail at Annex 2)

1. 2 compactors (one for marina and one for boatyard activities).
2. Emptying of compactors carried out by Veolia at the Lymington Waste Transfer Centre.
3. Recycling bins are provided for general recycling and cardboard.
4. Visiting boats receive a brochure showing, inter alia, compactor and bin locations. Notices state that bins are not to be used for food waste from outside the EU.
5. Waste oil tank is located near the marina building and is emptied regularly.
6. Tank cleaning is by arrangement with BKP.
7. Glass recycling is available with collection by NFDC.
8. All other waste is managed by specialist contractors as shown in Annex 2.

Yacht Clubs

Royal Lymington Yacht Club provides bins for domestic refuse and glass from leisure boats for members only. Domestic waste is collected under contract through BIFFA, Coronation Rd, Cressex, High Wycombe HP12 3TZ. Waste Carrier Contract No:514/2337237/1/04800000. Glass is collected under contract through New Forest District Council (NFDC), Appletree Court, Beaulieu Road, Lyndhurst SO43 7PA. Waste Carrier Licence CBDL45387.

Lymington Town Sailing Club provide bins for domestic refuse and glass from leisure boats for members only. Domestic waste is collected under contract through BIFFA, Coronation Rd, Cressex, High Wycombe HP12 3TZ. Waste Carrier Contract No: 514/1245614/1/00303100. Glass is collected under contract through New Forest District Council (NFDC), Appletree Court, Beaulieu Road, Lyndhurst SO43 7PA. Waste Carrier Licence CBDL45387.

Wightlink Ltd

Wightlink operate 3 ro-ro ferry's providing a frequent scheduled domestic vehicle and foot passenger service between Lymington and Yarmouth, Isle of Wight. Wightlink are the Statutory Harbour Authority for their terminal and produce their own Port Waste Management Plan for certification by the MCA. As soon as their vessels leave the terminal berths they enter harbour waters controlled by Lymington Harbour Commissioners.

Wightlink vessels are classed as 'Class IV passenger ships engaged only in voyages within category D waters and therefore fall outside the scope of the 2003 Regulations.

8. Time Expired Pyrotechnics (TEPs)

Leisure Users

On the 9th February 2010 the MCA issued updated guidance for the disposal of TEPs by members of the public and from small independent fishing vessels.

The MCA currently provide a limited storage facility for some TEPs through HM Coastguard, prior to disposal. The owner of the TEPs will have to assure the MCA that all other routes for disposal have been



exhausted. The nearest Maritime Rescue Coordination Centre to Lymington that will accept TEPs is MRCC Solent – Tel: 023 9255 2100 (appointment required).

Lymington Yacht Haven will accept TEPs from its own customers and undertake disposal; a small fee is charged.

Commercial Organisations

HM Government website (<https://www.gov.uk/guidance/disposing-of-unwanted-marine-flares>) gives the following advice for disposing of out-of-date TEPs from commercial organisations:

1. Some pyrotechnic suppliers or their agents(s) may have a collection and disposal scheme in place and may be able to accept TEPs.
2. Ask a life raft service station if they are able to take out of date TEPs.
3. Ask the port, harbour or marina where your vessel is berthed if they will accept TEPs (Note: None of the organisations on the Lymington River accept TEPs except Lymington Yacht Haven).
4. Ask the local council, they may be accepted at local recycling centres.

9. Review

This plan will be reviewed with the consultees (above) every 12 months to ensure that it is ‘current’. A copy of the reviewed plan will be submitted to the MCA on an annual basis. The MCA will determine when they need to undertake a formal review and recertification. This will normally only be required in the event of a significant change in the scale and arrangements for waste disposal.

Ryan Willegers

Harbour Master - Lymington Harbour Commissioners



Appendix 1 Lymington Yacht Haven

App 1.1 Domestic Waste

Eight mobile skips are provided and rubbish is then processed on site in a waste compactor which is emptied under contract once a month (out of season), and twice a month during the season by Veolia Environmental 210 Pentonville Road, N1 9JY: Tel 02078 125000. Waste Carrier Licence Number CBDU95537

Use of the waste bins is free to all marina users and signs are displayed indicating that they are not to be used for non-EU food waste. Lymington Yacht Haven's EU waste is disposed of at Lymington Harbour Commissioners by way of a contracted collection service. Every boat visiting the marina is given a brochure containing useful information including the siting of the waste bins.

App 1.2 Glass

Recycling bins are provided for glass. These are emptied by New Forest District Council. Appletree Court, Beaulieu Road, Lyndhurst SO43 7PA: Tel 02380 285000. Waste Carrier Licence CB/VM3288KH.

App 1.3 Waste Oil /Oil Filters / Contaminated Waste

Waste Oil tanks are emptied by Slicker Recycling. There is no set schedule for the collection of this. When tanks are 2/3rds full, the contractor is asked to empty them. Waste Carrier Licence Number: **CBDU125624**. **Slicker Recycling, Lombard House, Anchor Drive, Worcester Road, Stourport on Severn, DY13 9BZ: Tel: 0330 159 8325.**

LYH has a quid pro quo agreement with Ropewalk Marine (an onsite tenant) who manage the disposal of contaminated waste (mainly rags and filters) together with old anti-freeze, under an annual contract with Pure Clean, Waste Carrier Licence Number CBDU225945.

The waste from the interceptor tanks on the fuel bay are emptied every year **or as necessary** under annual contract by Cleansing Services Group. Waste Carrier Licence Number **CBDU89037**. Cleansing Services Group, Chartwell House, 5 Barnes Wallis Rd, Segensworth, PO15 5TT.

Wash down area waste is collected under annual contract by **Cleansing Service Group**. Waste Carrier Licence Number **CBDU89037**.

The wet waste (grease trap) from the Haven Bar & Bistro is also emptied under annual contract by Cleansing Services Group. Waste Carrier Licence Number **CBDU89037**.

App 1.4 Batteries

Battery waste is collected **by Harry Frankcom - on an 'as needed' basis**. Waste Carrier Licence Number: **CBDU275291**.

App 1.5 Cardboard & Mixed Recycling

Two large front end loaders are provided for cardboard, plastic and paper. They are emptied under contract as required by BIFFA Waste Management, Coronation Rd, Cressex, High Wycombe HP12 3TZ. Waste Carrier License: **CBDU104360**.





App 1.6 Flare Disposal

Collected by EOD as required, Waste Carrier Licence: CB/BM3984UX

App 1.7 Pump-out, Black/Grey

Pump-out connected directly to the main public foul sewer.

App 1.8 Scrap Metal

Fenced compound area on site, collected as required by **Harry Frankcom CBDU275291 on an 'as needed' basis. Waste Carrier Licence Number: CBDU275291.**

Reviewed by Lymington Yacht Haven on 26.04.23.





- Businesses On-Site**
- 1 Nick Cox Chandlery
 - 2 Ropewalk
 - 3 Jeremy Rogers
 - 4 Offshore Powerboats
 - 5 Ocean Rigging
 - 6 Greenham Regis
 - 7/8 Haven Covers
 - 9 Lymington Yacht Charters
 - 10 Ancasta
 - 11 James Brooke Academy
 - 12 Discovery Shipyard

- Lymington Yacht Haven**
- Marina Office
 - Washroom facilities
 - Haven Bar & Restaurant
 - Berth Holders Car Park
 - Fuel
 - Hoist Dock
 - Recycling and Waste Disposal
 - Footpath

- Safety**
- Fire Extinguisher
 - Lifebuoy
 - Safety Ladders

Lost or can't find what you're looking for? Head for the marina office where there is always somebody to help you.

A/B bin compound
 Glass
 Mixed recycling
 UK waste
 Battery collection

F/G bin compound
 Glass
 Mixed recycling
 UK waste
 Battery collection

L/M bin compound
 Glass
 Mixed recycling
 UK waste
 Battery collection

Fuel dock
 Pump out

Workshop area
 Waste oil bund
 Scrap metal

Main waste compound
 General waste compactor
 Mixed recycling large bin

Mobile dry mixed recycling bin
 Mixed recycling large bin (mobile)



Appendix 2 Lymington Marina / Berthon Boat Company

App 2.1 Domestic Waste

There are two waste compactors on site, situated at the marina and M shed. Every boat visiting the marina is given a brochure containing useful information including the siting of the waste bins. Veolia, Lymington Waste Transfer Centre, Lymington.

Waste Carrier Licence CB/DU95537. Veolia Environmental, 210 Pentonville Road, N1 9JY: Tel 02078 125000.

App 2.2 Dry recycling

Recycling bins are provided alongside the marina compactor above for paper, plastics and card; other general recycling collected by Veolia. Waste carrier licence CB/DU95537.

App 2.3 Glass

Recycling bins are provided alongside the bins above for bottles and jars. NFDC, Appletree Court, Beaulieu Road, Lyndhurst SO43 7PA: Tel 02380 285000. Reference number 6025: emptied every other Friday

App 2.4 Cardboard & shredded paper

Cardboard is compacted at M shed stores cardboard compactor and baled for collection by Veolia. Waste carrier licence CB/DU95537.

App 2.5 Waste Oil and Oil Filters

Disposal of waste oil is provided for via a disposal tank situated near the marina building and is accessible at all times. This tank is emptied on a regular basis. Two oil filter disposal bins are sited alongside the oil tank. Oil and filters are taken away by Cleansing Service Group Ltd, Waste Carrier Licence number CB/DU89037, Barnes Wallis Road, Fareham PO15 5TT; Tel 01489 782232.

App 2.6 Brown/Black Water Tank Pump Out

Tank cleaning and disposal of liquid and sludge wastes can be carried out at short notice by BKP, Waste Carrier Licence Number CB/DU201880. BKP Waste & Recycling Ltd, Casbrook Park, Bunny Lane, Romsey SO51 0PG. Tel 0800 3765004.

App 2.7 Scrap Metal

Large skip kept on site, collected as required by: New Forest Metal Recycling, Waste Carrier Licence No. CBDU85368, Unit 14, Brokenford Lane, Totton, Southampton SO40 9DY, Tel 02380 661060.

App 2.8 Batteries

On site storage in locked containers, collected as required by New Forest Metal Recycling, Waste Carrier Licence No. CBDU85368, Unit 14, Brokenford Lane, Totton, Southampton SO40 9DY, Tel 02380 661060

App 2.9 WEEE

On site storage. Collected as required by: New Forest Metal Recycling, Waste Carrier Licence No. CBDU85368, Unit 14, Brokenford Lane, Totton, Southampton SO40 9DY, Tel 02380 661060.



App 2.10 Small Batteries

On site storage. Collected as required by Cromwell Tools Ltd under WEEE Regs. Cromwell Tools, Unit 15 Admirals Park, Williams Road, Portsmouth PO3 5NJ.

App 2.11 Oily Bilge Water, Waste Diesel, Anti-Freeze

On-site banded storage in IBCs, collected by BKP, waste carrier licence No CB/DU201880.

App 2.12 Gunwash, Thinners, Paint Waste & Solvent

On-site banded storage, collected by BKP Ltd. Waste Carriers Licence No CB/DU201880

App 2.13 Motor Vehicle Waste & Parts Cleaner

Collected by NCH Puresolve, Waste Carrier Licence Number CB/DU374470. NCH UK Ltd, Springvale Industrial Park, Bilston WV14 0QL Tel 01902 510333.

App 2.14 Resin & Waste Acid

On-site banded storage, collected by BKP, Waste Carrier Licence Number CB/DU201880.

App 2.15 Fire Extinguishers (Halon)

Collected by Fireguard, Waste Carrier Licence Number CB/DU151334. Fireguard Safety Equipment Co Ltd, Unit 11 Chancel Ind Estate, Newhall St, Willenhall WV13 1NX.

App 2.16 Fluorescent Light Recycling

Collected by Kew Electrical, Unit 730 Ampress Park, Lymington SO41 8LW, under WEEE Regs.

App 2.17 Waste Petrol

Pumped directly from fuel tanks by BKP and transferred from site immediately. No large quantities of waste petrol are stored on site. Waste Carrier Licence CB/DU201880

Reviewed by Lymington Marina / Berthon Boat Company on 19.05.23.

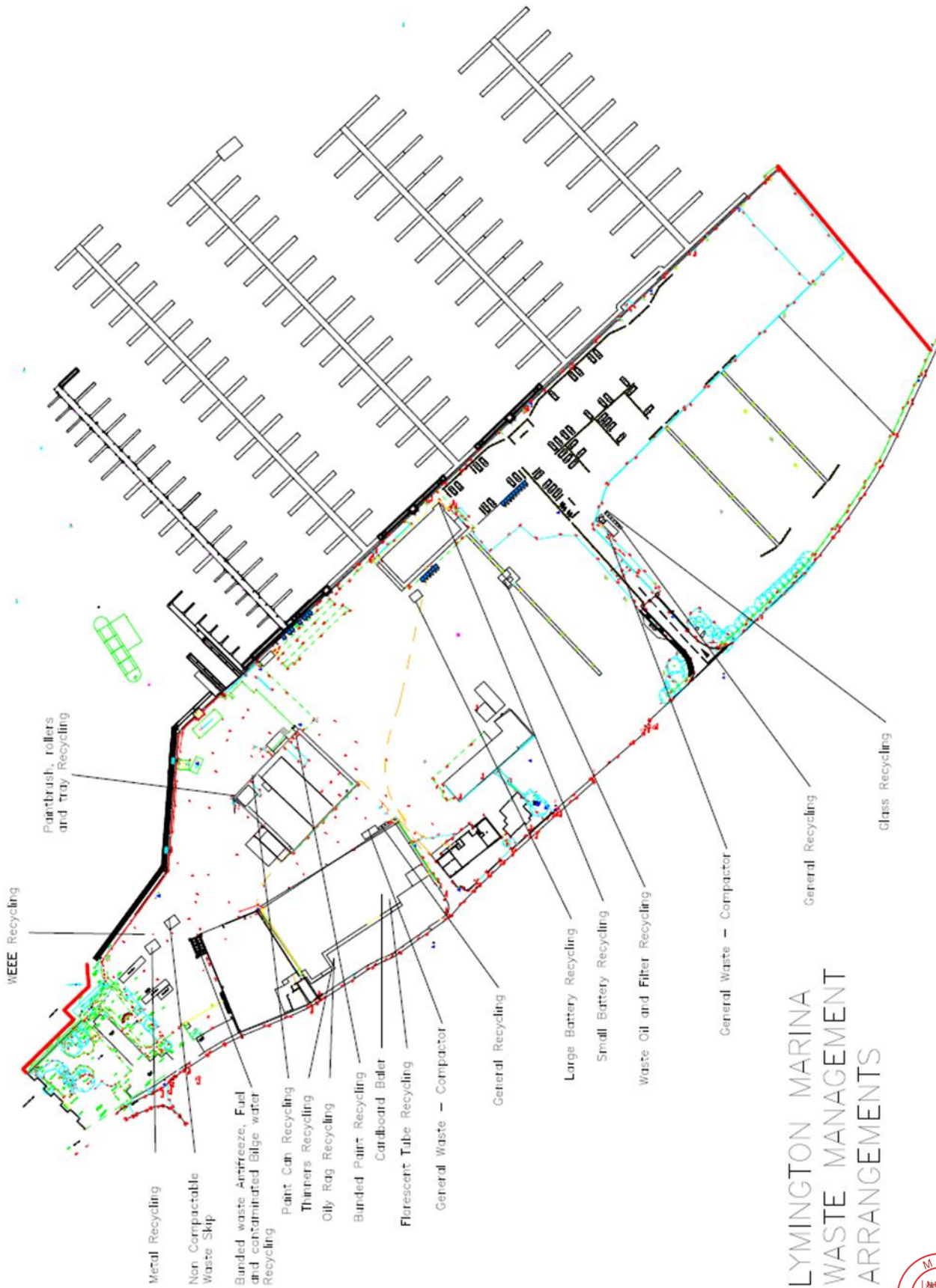

LYMINGTON MARINA
WASTE MANAGEMENT
ARRANGEMENTS

